



Industrial



Buildings for industrial use are often required to satisfy a number of contrasting needs - from production and processing plants to warehousing and offices. Occasionally, the building will also serve as a showcase for the company's products. Understanding how to accommodate a client's needs within the parameters of current planning policy is the first stage in securing a successful design. Meticulous planning from the outset ensures that optimum space and running cost efficiencies can be achieved.



New Production Facility

Established in 1987, Scotherbs has grown rapidly to become one of the leading growers and suppliers of fresh culinary herbs in the UK, counting Tesco and Asda amongst its customers. As increasing demand for their products began to put pressure on their existing premises, Scotherbs engaged Wellwood Leslie to conduct a feasibility study into the development of a new custom built headquarters which would provide them with excellent office space as well as triple the operational capacity and allow for potential future expansion.

Using the latest 3D modelling software, Wellwood Leslie were able to demonstrate the different stages of the industrial process to ensure that the facility would provide the most efficient and cost effective continuous operation. Constant temperature control, particularly in the cold storage areas, was a vital component of the design brief. The result is a purpose built pack house which enables Scotherbs to preserve quality control throughout the cleaning, chopping and packaging processes.

Industrial Scotherbs, Longforgan near Dundee

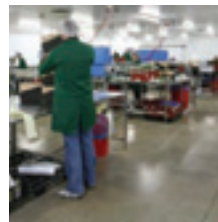
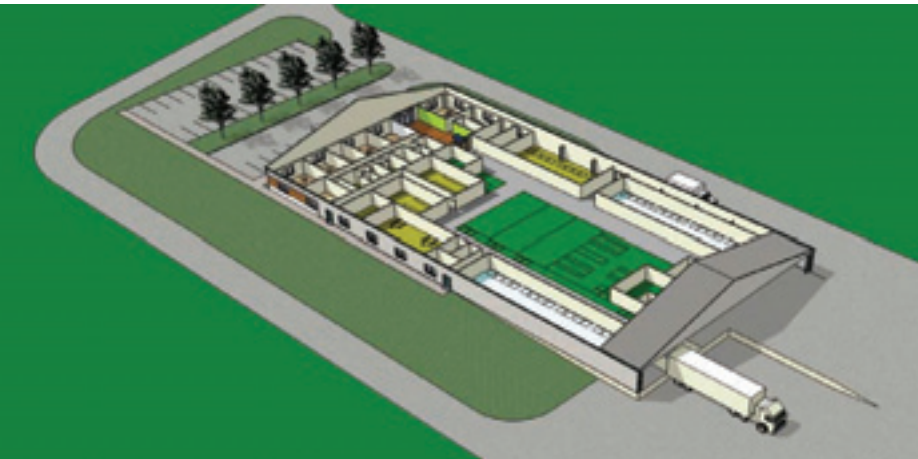

By using attractive timber cladding at the entrance to the company, Wellwood Leslie have given the building a distinctive appearance which reinforces the company's wholesome brand image and gives it a character beyond that of a generic industrial unit.

Having a new unit which meets all the needs of their specialised industry has enabled this pioneering company to expand not only their product range, but also the ability to offer their customers a bespoke packaging facility. By working closely with the client throughout the design and build stages of this project, Wellwood Leslie have been able to deliver a sustainable, state of the art facility in tune with Scotherb's own innovative approach.

'One of the leading growers and suppliers of fresh culinary herbs in the UK, counting Tesco and Asda amongst its customers.'